

MARIABU

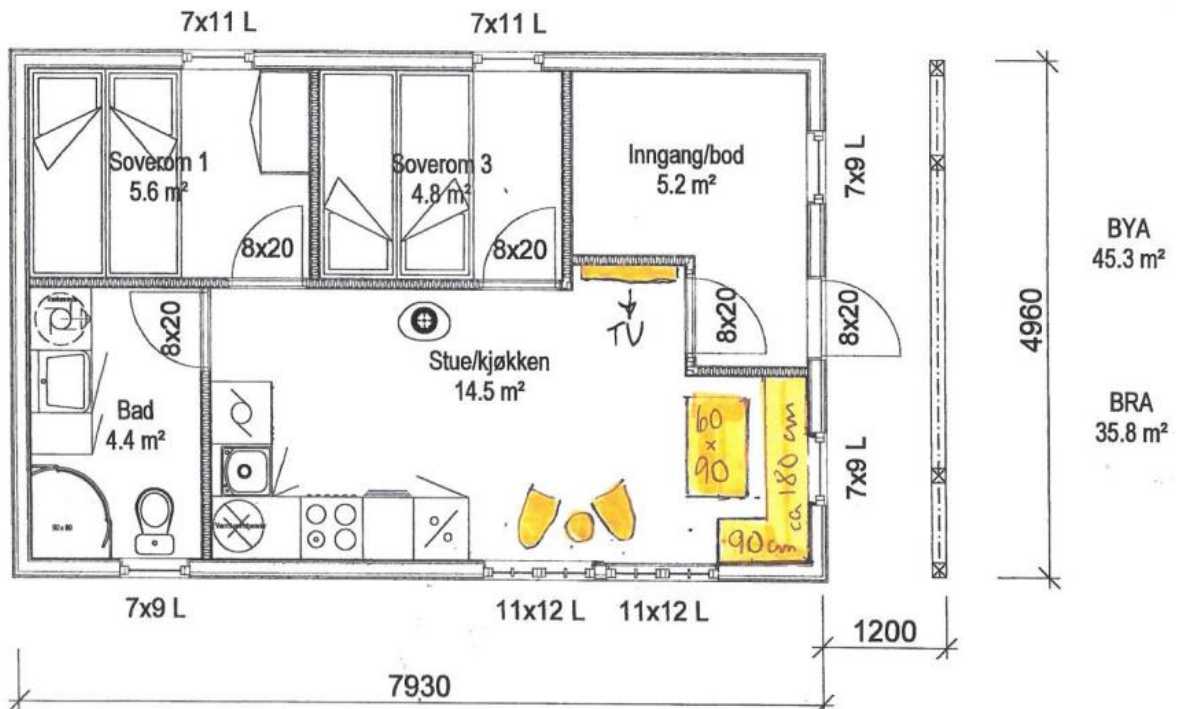

<p>Soverom 1</p> <p>Dobbeltseng (2 sengeplasser)</p>	<p>Beboere:</p>
<p>Soverom 2</p> <p>Familiekøye (2 ev. 3 sengeplasser)</p> <p>Dobbel underkøye 120 cm</p>	<p>Beboere:</p>

Til dobbel underkøye trengs stort stretchlaken